



# Care and Use Manual Drinking Water Systems

**Information Provided for the Proper Set-Up, Installation and Start-Up of the following Filtration Systems**

**#In-Line Filtration Units:**

FUSED100, FUCAC100, FUCAC150

**#Two Stage Undercounter Drinking Water Filtration Units:**

FUCAC200, FUCAC250, UU250

**#Three Stage Undercounter Drinking Water Filtration Units:**

FUCAC300, FUCAC350, UU350



DOO# SURGXFW# SURXGO\ # PDQXIDFWXUHG#DQG#DVVHPEOHG# LQ#WKH# XVD

**To the Installer: Please Read and Leave this Owner's Manual with the Unit or the Consumer**  
**To the Consumer: Retain this Care & Use Manual for Product Registration and Future Reference**



## Installation of the Filtration System

**You may need the following for proper installation:**

- Drill and drill bits
- Straight and Phillips Screwdriver
- Adjustable Wrench
- Pliers
- Teflon tape
- Work Gloves
- Safety Glasses
- Knife or scissors

\* Additional tools will be required for installation on sinks without a pre-drilled faucet location.

**WARNING:**

Verify that all components are included with the unit and were not lost, misplaced, or damaged in shipping or handling.

**CAUTION:**

Do not attempt to install this system using defective or damaged components. Check and inspect, inlet and outlet fittings and any other connections on this system that might have been damaged during shipping and handling.

## Summary Procedures for Proper Installation of these Water Filtration Systems

. **Dispenser/Faucet Installation and Mounting**

(In-Line Units do not include dispensers)

. **Inlet Water Connection**

. **Placement of the Water Filtration System**

. **System Interconnection**

. **System Start-Up and Operation**



## Dispenser/Faucet Installation

### Preparing a Location for the Dispenser/Faucet Professional Installation is Strongly Recommended

#### Step 1: Select a standard sink location to mount the faucet.

It is recommended that the faucet be placed in the extra hole provided on most sinks usually used for the sprayer or soap dispenser. If this is not possible, an alternative location will be required:

**Option A:** Another option is to drill a new hole into the sink rim itself, if space allows.

**Option B:** On the countertop next to the sink. Position to allow the faucet spout to drain into the sink. This requires a 2" clearance around the faucet--both above and under the countertop.

#### Step 2: Prepare to drill the hole using the dispenser as a template.

- Sinks can be made of, but not limited to, stainless steel, copper, porcelain/steel, enamel/cast iron, man-made surfaces, and/or materials known or unknown at this time.
- Countertops can be made of, but not limited to, or be a combination of, natural stone, enamel, porcelain, concrete, wood, metals and/or man-made materials known or unknown at this time.

**CAUTION:** Please consult with the sink or countertop manufacturer, fabricator, or installer for proper drilling techniques and methods.

EXTREME CARE MUST BE TAKEN IN DRILLING THE HOLE FOR ANY SURFACE. THE SURFACE MATERIALS OF SINKS AND COUNTERTOPS CAN CHIP OR CRACK. THE MANUFACTURER ASSUMES NO RESPONSIBILITY FOR ANY DAMAGE RESULTING FROM THIS INSTALLATION.

**WARNING:** USE SAFETY GLASSES OR OTHER EYE PROTECTION WHEN GRINDING OR DRILLING TO PREVENT POSSIBLE EYE INJURY DUE TO FLYING PARTICLES.

### Go to: Mounting the Faucet.

**Q:** I do not want to drill any extra holes or use a separate dispenser/faucet - what can I do?

**A:** There is an alternative to installing and using the dispenser/faucet. Consider a simple, direct connection to your kitchen (cold side) faucet. Simply connect the supply from the cold water angle stop to feed/inlet side of the filtration system. Then connect the filtered/outlet side to the cold feed side of the kitchen faucet. Special fittings, that are readily available to the plumbing professional, will be required to fit this application based on line size and materials used.

**Note:** There will be a diminishment in your flow rate to the cold side of the faucet and to get filtered water you must be sure you have the faucet to the cold side only. This is not applicable for reverse osmosis systems.

**Q:** I would like to use another dispenser/faucet?

**A:** Based on many styles and finishes, a consumer may have another dispenser they would like to use. No problem, all these items have universal or industry standard fittings, or if not, can be easily adapted to fit.

**Note:** EWS Agua includes a standard chrome, long-reach, lead-free faucet with white handle and tip. However, you have an option to upgrade to black handles and tips, or to an all white faucet, or satin nickel with black handle and tip, at a small additional charge. Inquire with your local EWS Agua distributor or visit us on the web.

**Q:** Can we connect the filtered water up to other devices?

**A:** Yes, simply connect by a "T" connection, the filtered water line to any instant hots, chillers, ice-makers, refrigerators, etc. Be mindful of too many (3 or more) connections or see our whole home appliances to filter the whole home.



## Mounting the Dispenser/Faucet

Once the location for the Dispenser/Faucet has been prepared follow the remaining step by step instructions to mount and secure

### Step 1: Locate faucet parts bag.

<b>Parts Included:</b>	faucet body with handle, faucet spout with tip, decorative washer, black rubber washer, white beveled washer, lock washer, hex nut, 1/4" tube insert sleeve, 1/4" plastic compression ferrule, 1/4" compression nut
<b>Optional Part:</b>	flat white washer (for use under decorative washer depending on hole/application)

### Above the Surface

#### Step 2:

Place decorative washer to bottom of faucet body (optional: place flat white washer under decorative washer)

#### Step 3:

Place black rubber washer below decorative washer (or below optional flat white washer)

#### Step 4:

Place faucet stem through hole and center

### Below the Surface

#### Step 5:

Insert white beveled washer, bevel side up to fit snugly into a pre-drilled hole or flat side up depending on the application

#### Step 6:

Place lock washer on

#### Step 7:

Spin hex nut onto faucet stem and tighten hex nut and washers into place

#### Step 8:

Insert 1/4" tube insert sleeve into 1/4" filtered water line

#### Step 9:

Slide 1/4" compression nut (threads up) onto 1/4" filtered line

#### Step 10:

Slide 1/4" plastic compression ferrule, long side down onto filtered water tube. Ferrule will seat into compression nut

#### Step 11:

Insert 1/4" filtered water tube into faucet stem

#### Step 12:

Thread 1/4" compression nut onto faucet stem and tighten

### Std.\*\* Dispenser/Faucet Dimensions:

Height:

from deck to top of dispenser 8"

from deck to tip of dispenser 61/4"

Reach:

from center of dispenser to tip 6"

Hole: minimum required 1/2"

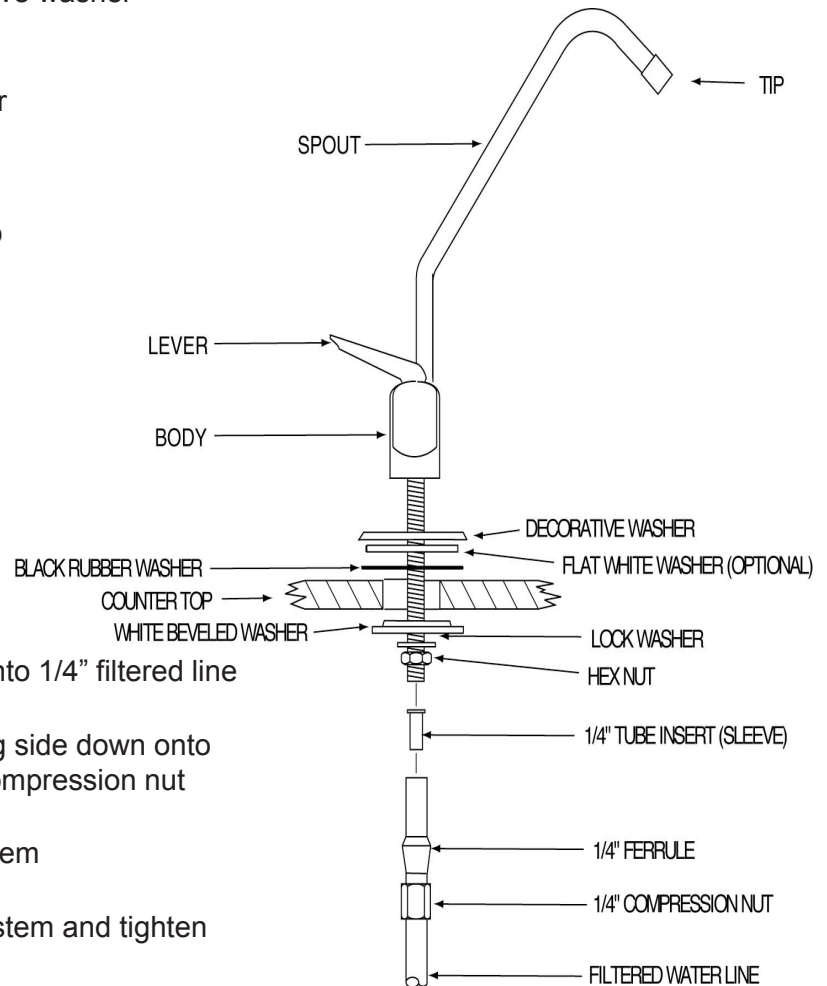

### CAUTION: Do not overtighten fittings

**Note:** Spout pulls out from faucet body that's why it swivels. Spout has 2 o-rings at base and is inserted completely into bottom of body to prevent leaking. Handle and tip can also be removed.

\*\*Other faucets check specifications, all dimensions are approximate.

**Dispenser/Faucet Installation is now Complete. Go To Inlet Water Connection**



# Inlet Water Connection - All Units

## Professional Installation is Strongly Recommended

This unit is supplied with a saddle tapping valve and is a proper connection for 1/2" hard copper lines only. A qualified plumber may/will choose to use another adapter to connect the feed water supply.\*\*

### Instructions if using the supplied saddle tapping valve

**Step 1:** From parts bag locate: saddle tapping valve and 4' of 1/4" tubing, color coded: red or orange.

**Step 2:** Locate cold water line that feeds your existing faucet. Determine if there is enough space to install the saddle tapping valve on the 1/2" copper line between the wall and the angle stop.

**CAUTION:** USE ONLY COLD WATER LINE. NOT INTENDED FOR SUPPLY BY HOT WATER.

**Step 3:** Shut off the main water supply to the house and open the faucet to relieve water pressure in the 1/2" copper pipe. **NOTE:** Shutting the angle stop only, still leaves water in that pipe. Shut the main supply.

**Step 4:** Loosely assemble saddle tapping valve around 1/2" copper pipe with "V" notch of the bottom bracket towards pipe.

**CAUTION:** Do not turn valve handle before instructed to do so. Make sure the piercing lance does not protrude beyond the rubber gasket.

**Step 5:** Tighten screws evenly. Make sure brackets are parallel, then tighten firmly until the valve is not moving on the pipe.

**CAUTION:** Do not over tighten.

**Step 6:** Connect the 1/4" plastic tubing to the saddle tapping valve by following these instructions:

**A:** Place 1/4" brass insert sleeve into the end of the 1/4" red or orange plastic tubing.

**B:** Slide 1/4" compression nut over plastic tubing with threads toward the saddle tapping valve.

**C:** Slide 1/4" plastic ferrule over plastic tubing with long tapered side towards compression nut.

**D:** Insert tubing into saddle tapping valve.

**E:** Tighten compression nut onto saddle tapping valve.

**CAUTION:** Do not over tighten.

**F:** Be sure the handle packing nut is tight, then turn the handle of the saddle tapping valve clockwise until it is firmly seated. **NOTE:** The 1/2" hard copper pipe is now pierced.

**G:** Turn the handle counter-clockwise to open the valve for water supply.

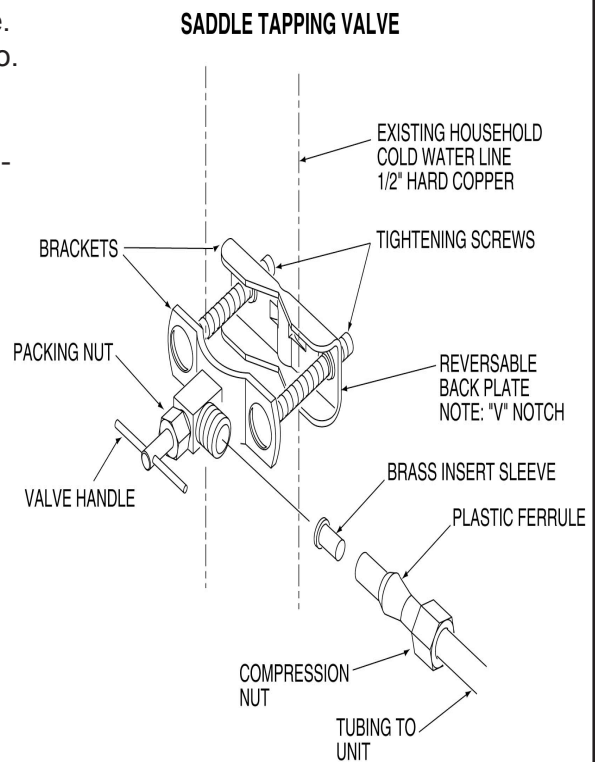

\*\*EWS, Inc. can not anticipate all the different locations, applications and materials used by your builder and/or plumbing contractor regarding your household or sink piping, therefore we offer a generic and common fitting with proper instructions. A qualified plumber, plumbing supply location, or hardware store will have no problem with alternative parts and advice necessary to install your unit.

### Water Supply/Connection Options:

There are a number of options to properly install any one of our water filtration systems. Identify the cold water supply line, the size/diameter and the material it's made from, along with any fittings you observe at the ends of the supply line.

Examples of connections available at your local hardware store

- BEST OPTIONS: 1/2" IPS x 3/8" compression x 1/4" compression 3-way angle stop
- BEST OPTIONS: 1/2" compression x 3/8" compression x 1/4" compression 3-way angle stop
- BEST OPTIONS: angle stop 2-way adaptor: install on the angle stop outlet which becomes a 2-way angle stop

**Note:** Be sure one outlet is 1/4" compression for water filter 1/4" inlet/supply tubing

Proper installation is dependent on your specific application. However, the idea is universal. Locate the supply pipe, shut off your water, install the proper connections and follow the remaining instructions in this manual.

**Inlet Water Connection is now Complete. Go To the Placement of the System**



## Placement of the Water System

Simply place the water system on a level floor, cabinet bottom or horizontal surface. Always assume for enough space and tubing to remove, move and/or adjust for filter replacement and maintenance.

If mounting the system to a wall, cabinet side or other vertical surface, see the following;

**Step 1:** All filter cartridges for the system are preinstalled. If the unit is installed in a permanent hanging position, a minimum clearance of 2" will be required to allow filter replacement.

**Step 2:** Mark pilot holes using the bracket as a template.

**Step 3:** Using a drill bit or punch, drill a hole or punch as a starter hole to catch the mounting screws.

**WARNING:** ALTERNATIVE FASTENING METHOD MAY BE REQUIRED FOR PLASTER BOARD, PARTICLE BOARD OR SIMILAR MATERIAL INSTALLATION. USE SAFETY GLASSES OR OTHER EYE PROTECTION TO PREVENT POSSIBLE EYE INJURY DUE TO FLYING PARTICLES.

**Step 4:** Set mounting screws (provided) with screw driver. Leave a 1/4" gap between the screw head and mounting surface to allow the bracket to slide on easily.

**Step 5:** Slide the bracket over the screws and hang the unit.

## Interconnection to Supply and Dispenser/Faucet

### Before Making the Connections

**NOTE:** This system may have come with sample tubing. Please remove before installation.

**WARNING:** DO NOT PULL OUT TO REMOVE. Follow simple instructions to remove.

**INSPECT:** Inspect the fitting for any damage from shipping and/or handling. **STOP**, if collet is damaged in any way; call, fax or e-mail customer service for a replacement fitting.

### Step 1:

Connect the blue colored tubing from the "Out" of the Post Filter to the Faucet. This is the filtered water line. Press firmly and insert the tubing completely into the fitting. If needed, cut tube straight and do not flatten.

### Step 2:

Connect the orange tubing from the Water Inlet Connection to the Prefilter, Feed or "In". This is the supply water to the system. Press firmly and insert the tubing completely into the fitting. Cut Straight. Do Not Flatten.

### Making the Connections

**NOTE:** You may feel a resistance at the o-rings when you insert the tubing. Firmly insert the tubing completely into the fitting.

**CAUTION:** ALWAYS CUT TUBING STRAIGHT (NO ANGLE OR SLANT) TO FORM A STRAIGHT END.

**WARNING:** NEVER ATTEMPT TO REMOVE TUBING BY JUST PULLING. Follow easy instructions.

**INSPECT:** Upon installation, inspect the connection and give the tubing a gentle "tug" to insure proper connection and integrity of the fitting.

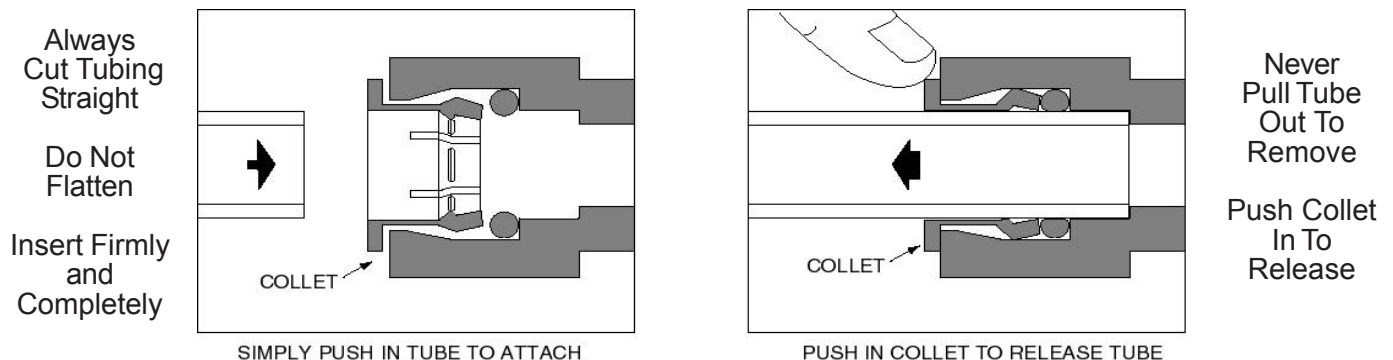



## System Start-Up and Operation - All Units

**Step 1:**

Connect UV lamp cord and plug in transformer unit to typical 110v electric outlet. (UU250, UU350 only)

**NOTE:** Electrical outlet must be unswitched. Be aware of any GFI outlets and the need to reset. Surge suppression recommended.

**Step 2:**

Pull up and lock dispenser/faucet handle, and/or allow water to flow in the open position.

**Step 3:**

Turn on any main water supply which was shut off earlier.

**Step 4:**

Open or make sure there is inlet water supply to the system.

**Step 5:**

Water will begin to flow from dispenser/faucet. Initially it may sputter until it reaches full flow.

**Step 6:**

Allow system to run steadily for approximately 2 minutes. This will wash all carbon fines and air from the system. End this flushing of the system once water runs clear. System is now available to use as normal.

**NOTE:** If you draw your water into a glass and it appears to be cloudy, it's only air and nothing bad. Let the glass sit and watch the air rise and dissipate. The filter cartridges used are full bed depth. The carbon (GAC) cartridges have a great deal of surface area. It may take 24-48 hours for this to correct itself.

**Step 7:**

Inspect for leaks at all connections. If a problem exists, please shut off water supply to the system and consider the following solutions;

- Plumbing connections are at the dispenser/faucet and inlet supply. Please review these procedures.
- Inspect for leaks at all system connections such as connections between housings, the cartridge housings and the in/out connections. Give a light "tug" (not a hard pull) on all tubing to check the grip on all fittings.

If there are any problems, please call or e-mail.

Please identify any damage in shipping or handling. You'll need to make a claim with the shipper, as indicated on your packing materials, the packing slip and the published terms of sale.

Please identify any problem and let us know if we can offer advice or a part that we can readily send you.

**WARNING:** Maximum pressure is 75 PSI. Pressure unregulated can surge or exceed the maximum rating on this and many items in the home. High pressure creates a water hammer or banging pipes. It's also the reason to use stainless hoses for washer machine connections and not the rubber. A pressure reducing valve (PRV) at your main water service line (if not code) is greatly recommended by many manufacturers' of many different household items, plumbing products and appliances.

### PLEASE:

- , Familiarize yourself with the system, its' replacement filters and maintenance.
- , Understand your system's capabilities.
- , See your options in water treatment, for you , your family and your home by EWS, Inc.

### REGISTER:

- , Register your system with our confidential data base and be reminded to replace your filters.



## Replacement of Filter Cartridges

It is recommended that filters be changed at least annually or more frequently based on usage and local water conditions. The quantity and quality of the water processed effects the life of the filters.

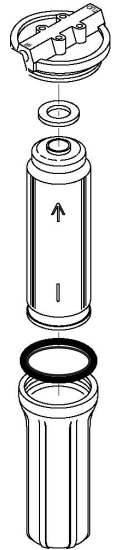

**Step 1:** Close inlet water supply to the system.

**Step 2:** Open dispenser/faucet. Lock handle in the up position and/or allow water to flow (water flow should stop in a short time) and keep open to relieve pressure.

**CAUTION:** WATER WILL BE PRESENT WHEN FILTERS ARE CHANGED.

A pan, towel, etc. should be placed under the housings to catch any water.

**Step 3:** Using your spanner wrench, turn housing base counterclockwise to loosen. Remove base.

**Step 4:** Remove filter from base and dispose.

**NOTE:** See disinfection procedure before replacing any filters or UV lamp (if applicable)

**Step 5:** Insert new filter(s), replace and tighten housing base by turning clockwise.

**CAUTION:** The GAC post filters have gaskets that must be at the top of the filter to be replaced correctly. All other filters do not have a top or bottom (or have gaskets) and can be inserted either way.

**CAUTION:** Inspect O-Ring for housing base. Make sure it is clean, free of any deris and not damaged or kinked. Make sure it is correctly seated into the channel inside the housing before replacement.

**Step 6:** FOLLOW SYSTEM START-UP PROCEDURES FROM PAGE 11

## Replacing the Ultra Violet Lamp

**Step 1:** Unplug the transformer. Disconnect the UV lamp cord.

**NOTE:**

- Two stage units - the UV module is set between the filter housings.
- Three stage units - the UV module is set on top of bracket (easier access)

**Step 2:** Pull firmly on the UV lamp tail to remove the lamp.

*Two stage units only:* Snap the UV module from the bracket clips to gain access for lamp removal.

**Step 3:** Insert and firmly press in new UV lamp until it meets the top of the cap. Reconnect UV lamp cord.

*Two stage units only:* Thread UV lamp cord through bracket hole and then snap the UV module back into the bracket clips.

**Step 4:** Plug in unit transformer.

**WARNING:** DO NOT DISCONNECT UV MODULE FROM THE FACTORY CONNECTIONS AND DO NOT OPEN UV CAP FROM UV MODULE FOR TYPICAL UV LAMP REPLACEMENT.

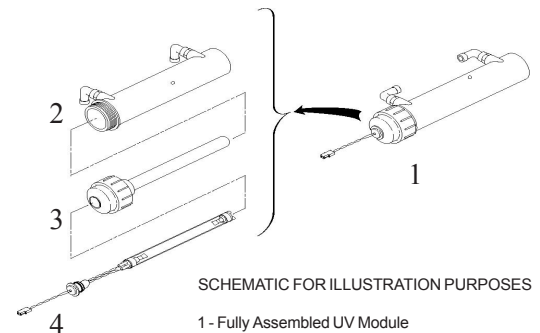

SCHEMATIC FOR ILLUSTRATION PURPOSES

- 1 - Fully Assembled UV Module
- 2 - UV Module Housing
- 3 - UV Cap with Quartz Glass Sleeve
- 4 - UV Lamp with Lamp Cord

**CAUTION:**  
FOLLOW SYSTEM INTERCONNECTION INSTRUCTIONS ON PAGE 10

When disconnecting and/or connecting tubing to the Quick Connect Fittings on the inlet (in/feed) and outlet (out/filtered):

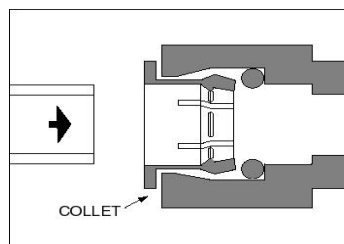

SIMPLY PUSH IN TUBE TO ATTACH

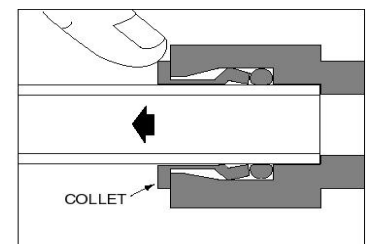

PUSH IN COLLET TO RELEASE TUBE

## Disinfection Procedure

This procedure may be performed at any time when changing filters or after extended periods of inactivity of the system.

**Step 1:** Follow Steps 1 through 4: Replacement of Filter Cartridges. Empty all housings of their filters.

**Step 2:** Using chlorine bleach, measure 1/2 cup and pour into first housing base (nearest the inlet/in/feed).

**Step 3:** Replace all housings and tighten. Take note of the housing O-Ring. Close dispenser/faucet to prevent water flow.

**Step 4:** Slowly Open water inlet valve and allow system to completely fill. Let water sit in system for at least 5 minutes (leaving it for a longer time will not hurt).

**Step 5:** Open dispenser/faucet and let the water run for at least 5 minutes. **WARNING: DO NOT USE THIS WATER.**

**Step 6:** Now that the system has been disinfected. Re-open the housings as in previous procedures and wipe away any residual found to totally clean this system prior to new filter and UV replacement.

- # FOLLOW STEPS 1 THROUGH 6 (Above): Replacement of Filter Cartridges and Replacing UV Lamp (if applicable)
- # FOLLOW STEPS 1 THROUGH 7 (Page 11): System Start-Up and Operation



### Trouble Shooting Guide - Drinking Water Filtration Systems

Problem	Possible Causes	Solution
No water	Water supply is off	<ul style="list-style-type: none"> <li>•Turn main water supply on</li> <li>•Turn water on at inlet connection</li> <li>•Open dispenser/faucet</li> </ul>
Not enough water	Low water pressure	Unit may not operate properly at less than 25 PSI feed line pressure (max: 75 PSI)
Leak at inlet or outlet fittings	<ul style="list-style-type: none"> <li>•Is the tubing cut with a straight end to grab squarley?</li> <li>•Is the tubing inserted completely into fitting?</li> <li>•Is there a problem with the collet and the quick-connect fitting?</li> </ul>	<ul style="list-style-type: none"> <li>•Access the filter unit, remove tubing by depressing the collet and pulling tubing out. Using a utility razor knife, squarely cut 1/2" off tubing from the end. Make sure end of tubing is not flattened Reinsert the tubing into the fitting as far as possible. Check for leaks.</li> <li>•Tug on tubing (do not pull hard) to check fitting</li> </ul>
Leak at connections to, or between housings	Damage in shipping/handling	Call for part replacement
Leak at faucet Leak at supply connections	Dispenser needs to be re-inserted Various Causes to inspect	Check connections at various locations and re-connect, re-insert, tighten and/or correct
Leak at cartridge housing	Misaligned, damaged or missing O-Ring(s)	<ul style="list-style-type: none"> <li>•Locate and Align O-Ring into groove inside housing</li> <li>•Call for replacement part</li> </ul>
Any/all leaks	Excessive Pressure	Pressure reducing valve (PRV) at main water supply to maintain pressure at or below 75 PSI
Water Flow is Restricted	Kinked or Bent Tubing	Make longer loop with tubing to remove kink or bend
UV not working	Lamp damaged, lamp cord has not been connected or transformer is not plugged in.	<ul style="list-style-type: none"> <li>•Connect lamp cord and/or Plug in transformer.</li> <li>•Make sure unit plugged into an unswitched electrical outlet. Check GFI reset.</li> <li>•Surge suppression recommended</li> <li>•Replace UV Lamp,</li> </ul>
Unpleasant taste and/or odor Metallic flavor Discoloration Rotten egg smell from water	<ul style="list-style-type: none"> <li>•Need to replace filters</li> <li>•System needs disinfecting</li> <li>•System was idle, stored or misused for a long period of time.</li> <li>•System under unfavorable conditions or changing water conditions</li> <li>•Hydrogen sulfide, iron, manganese is in the household water supply</li> <li>•System misapplied</li> </ul>	<ul style="list-style-type: none"> <li>•Replace filters and follow start up procedures</li> <li>•Replace and disinfect: See page 12 for instructions</li> <li>•Flush system by running water, replace filters and/or disinfect</li> <li>•Determine what changed in your water supply and Flush, Replace and/or Disinfect, or change type of water treatment system based on local water conditions. Call your municipality or have your well tested.</li> <li>•Hydrogen sulfide, iron and manganese must be removed from household water supply before filter system. Visit our web site and see the Pyrolox systems</li> <li>•The wrong system for the application</li> </ul>
Low flow from unit	Clogged prefilter cartridge	Replace sediment and/or other filters
Cloudy water	<ul style="list-style-type: none"> <li>•New installation, changing filters, disinfecting the system</li> <li>•Open/close and open of water supply to home or in home</li> </ul>	It is simply - air. Check by filling glass and watch air dissipate. Run and flush system for several minutes. Sometimes it takes 24 - 48 hours to totally clear due to the full bed depth of our filters



Model #: FUGAC200

Ref#	Part	Description
1	h-filter	Housing base
1a		Upper housing
2	93023	5 Micron Pre-Sediment Filter Cartridge
3	fc-std-all	JG 1/4"x1/4"m-white quick connect
4	bracket-2	aluminum bracket, powder coat
5	fd-ch-wh	Std chrome w/wh, long reach
6	stv-2	saddle tapping valve
7	t-blue	1/4" pe tubing 60" bl-p
8	t-orange	1/4" pe tubing 60" or-p
9	UDF10HP	GAC Filter Cartridge
10	h-f-o-ring	Housing base o-ring
11	fc-fu-conn	Dual male connect between housings

**Filtration Unit FUGAC200**

Schematic, Parts, Installation:  
for illustration purposes only

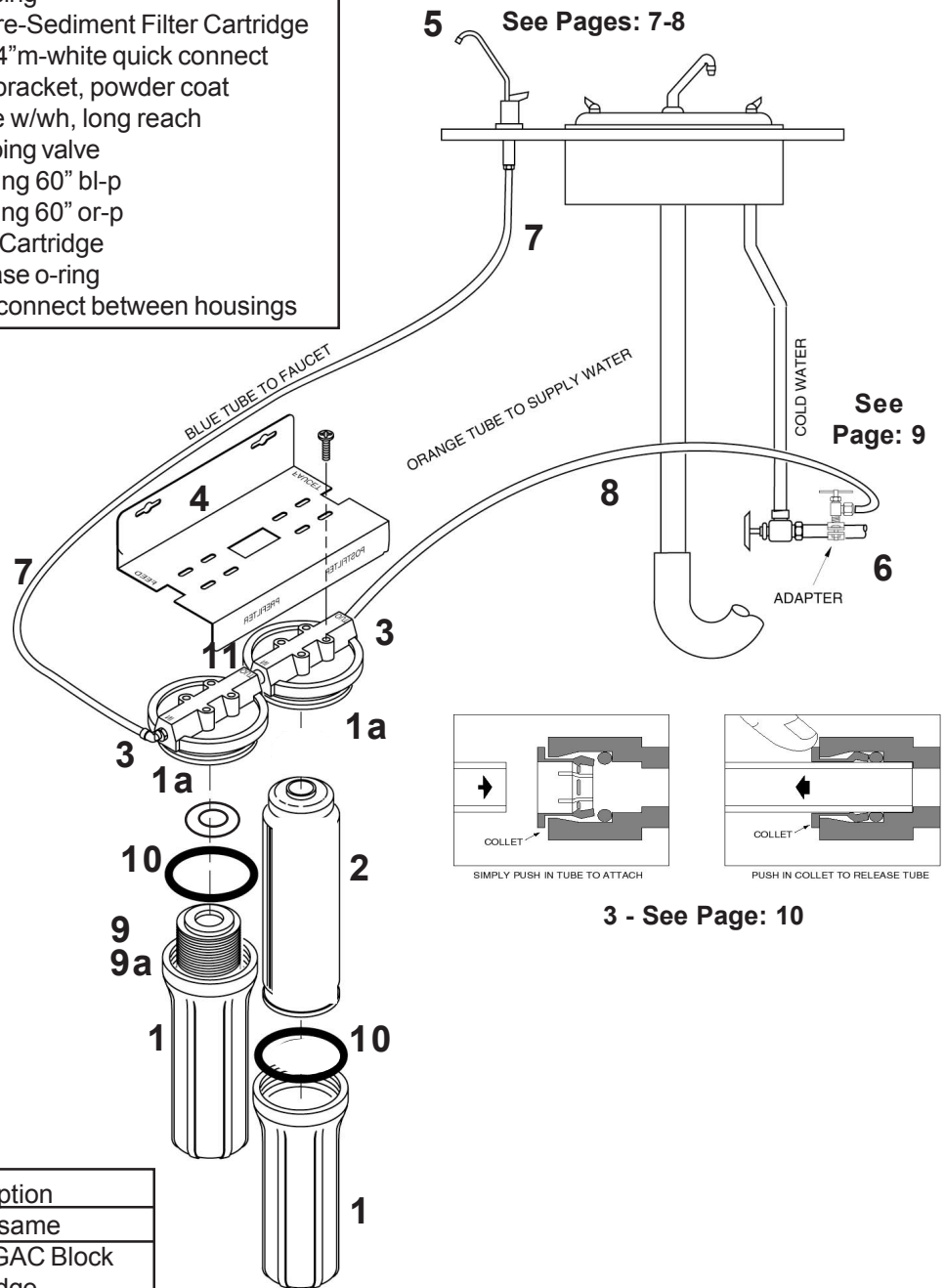

Model #: FUGAC250

Ref#	Part	Description
1-8,10,11	all items	remain the same
9a	PB-1	Upgraded GAC Block Filter Cartridge (replaces UDF10HP)

Model #: FUGAC300, FUGAC350

Ref#	Part	Description
1-8,10,11	all items	remain the same
9 or 9a	GAC filters	Depends on unit
Add (not pictured) 1,10,11 add'l housing for 3rd stage		
2a	WB-20-W	20 micron pleated filter
4 to 4a	bracket-3	alum bracket 3 stage

Models #: FUSED100, FUGAC100, FUGAC150  
In-Line Filtration Units

Ref#	Part	Description
1,3,6,7,8,10	all items	remain the same
2, 9, OR 9a	Filters	Depends on unit
4b (not pictured)		In-line single bracket

Not pictured: spanner wrench (all units)



**Upgraded Filtration Unit  
with UV Disinfection Option  
UU250**

Schematic, Parts, Installation:  
*for illustration purposes only*

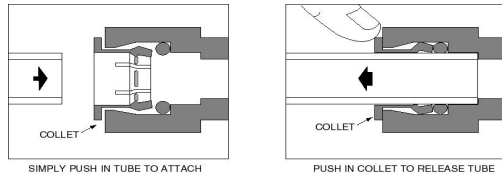

3 - See Page: 10

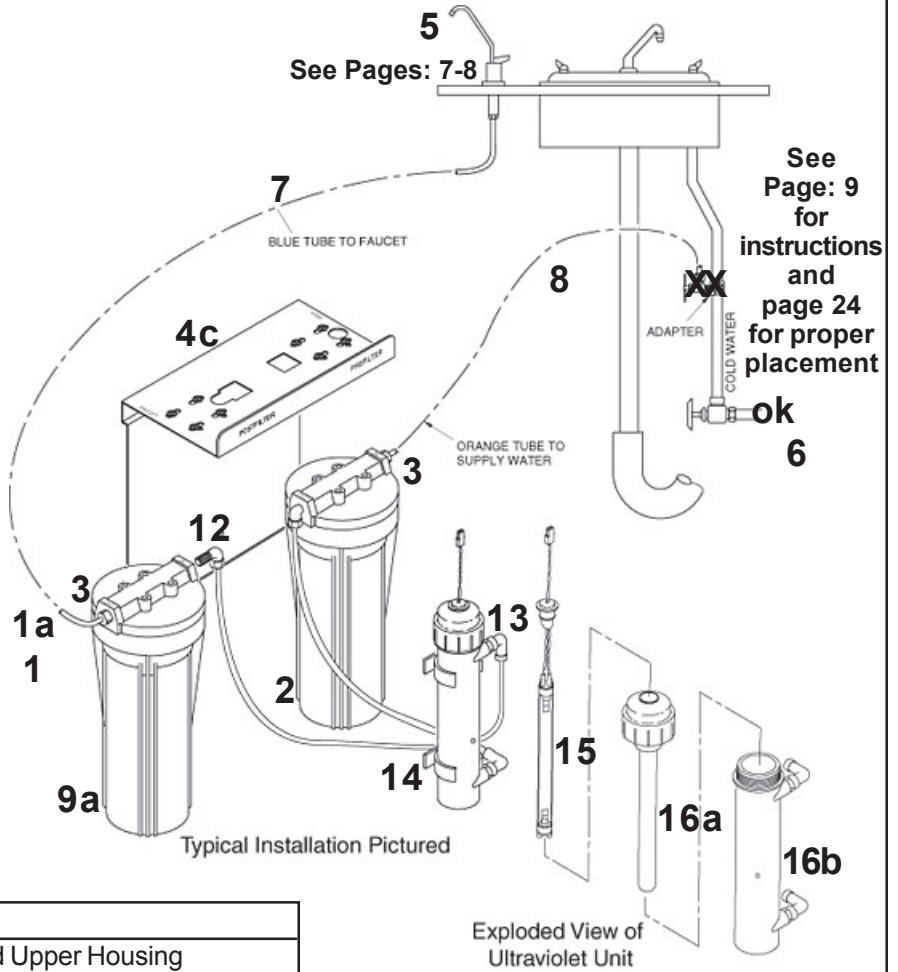

Typical Installation Pictured

Model #: UU250

Ref#	Part	Description
1,1a	h-filter	Housing base and Upper Housing
2	**93023	5 Micron Pre-Sediment Filter Cartridge
3	fc-std-all	JG 1/4"x1/4"m-white quick connect
4c	bracket-uv2	aluminum uv-2 bracket, powder coat
5	fd-ch-wh	Std chrome w/wh, long reach
6	stv-2	saddle tapping valve
7	t-blue	1/4" pe tubing 60" bl-p
8	t-orange	1/4" pe tubing 60" or-p
9a	**PB-1	Upgraded GAC Block Filter Cartridge
10	**h-f-o-ring	Housing base o-ring
12	fc-jg-90	JG 1/4 x 1/4 elbow
13	fc-uv-jaco	Jaco compression @ uv module
14	h-u-clip	Bracket clip uv housing
15	UST-200-RL	UV Replacement Lamp with Cord
16a	h-uv	UV assembly cap with quartz glass sleeve
16b		UV housing with housing o-ring
17	**pou-uv-e68	UV Transformer

\*\*Not pictured:  
Part not pictured in this schematic

Additional Part Included:  
spanner wrench (all units)

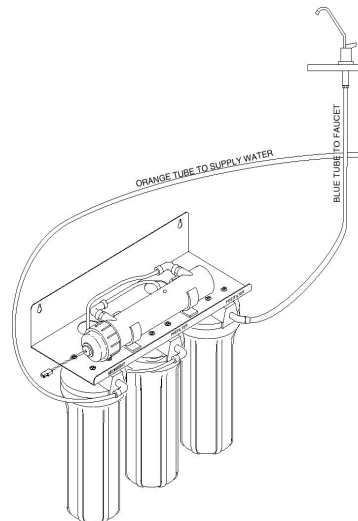

Model #: UU350 (Graphic to the right)

Ref#	Part	Description
1-17	all items	remain the same
Add		
1,10		add'l housing for 3rd stage
2a	**WB-20-W	20 micron pleated filter
4c to 4d	bracket-uv3	alum uv-3 bracket



The complete EWS Agua / Environmental Water System product line from sink to whole-home, available through:

Available on the Internet through Authorized Retail Web Distributors and Business-to-Business E-Commerce Distributors.

Available through Authorized Building Wholesale Supply Locations, Kitchen & Bath Showrooms and Appliance Dealers, and their Building and Plumbing Contractors throughout the United States.



**EWS Agua**  
**Environmental Water Systems**  
A Complete Line of Water Filtration Product from Sink to Whole-Home

Corp. Offices: Las Vegas, Nevada  
Mailing: PO BOX 981611, Park City, UT. 84098

Telephone: 702-987-4549 Fax: 702-987-4583  
E-Mail: [servicio@ewsagua.com](mailto:servicio@ewsagua.com)  
Visit us on the web at: [www.EWSAgua.com](http://www.EWSAgua.com)

This service guide and all materials herein is the property and copyright of EWS, Inc. 05/03: 051803



**Providing information to help consumers.**  
**All Product Proudly Manufactured and Assembled in the USA**

[www.EWSAgua.com](http://www.EWSAgua.com)